

# **Bond 2016 Community Meeting**

Chief Operations Officer Willie Burroughs



# Bond 2016 - Input

---

Community Advisory Committee – Quarterly meetings, beginning June 14, 2017

District 1 Committee Members

- Brian Dillard
- Shannan Hern
- John Wilkins

Meeting with campus Principals – April 17, 2018

- Jennifer Benavides, Health & Law Principal
- Kathy Bieser, Advanced Learning Academy Principal

Meeting with campus Principals – May 18, 2018

- Jennifer Benavides, Health & Law Principal
- Kathy Bieser, Advanced Learning Academy Principal

Meeting with campus Principals – June 19, 2018

- Jennifer Benavides, Health & Law Principal
- Kathy Bieser, Advanced Learning Academy Principal
- Dr. Melissa Alcala, CAST Tech Principal

# Bond 2016 - Input

---

*\*New Central Office Community Meeting – July 11, 2018*

*\*New Central Office Community Meeting – July 25, 2018*

Meeting with campus Principals – August 9, 2018

- Jennifer Benavides, Health & Law Principal
- Kathy Bieser, Advanced Learning Academy Principal
- Dr. Melissa Alcala, CAST Tech Principal

*\*New Central Office Community Meeting – August 22, 2018*

Stakeholder Meeting – September 24, 2018

- Steve Lechlop, Trustee
- Jennifer Benavides, Health & Law Principal
- Kathy Bieser, Advanced Learning Academy Principal
- Isabel Garcia
- Lindsay Unsworth
- Cindy Robinson
- Kellen Morgan
- Marisa DeLaverda
- Tiffany Jenkins
- Tristan Taylor
- Milly Elliott

# Bond 2016 - Scope

Total Construction Budget: \$26,264,880

Renovations and upgrades to include:

- Classroom spaces (general learning, science, special education)
- Restrooms
- Cafeteria/kitchen
- Heating, ventilation and air conditioning
- Plumbing and electrical
- Technology infrastructure for new and renovated spaces
- Lighting
- Fire sprinkler systems
- Special needs accessibility in entryways, restrooms, and other areas
- Front-entry modifications to improve security
- Roofing, building exterior and site improvements

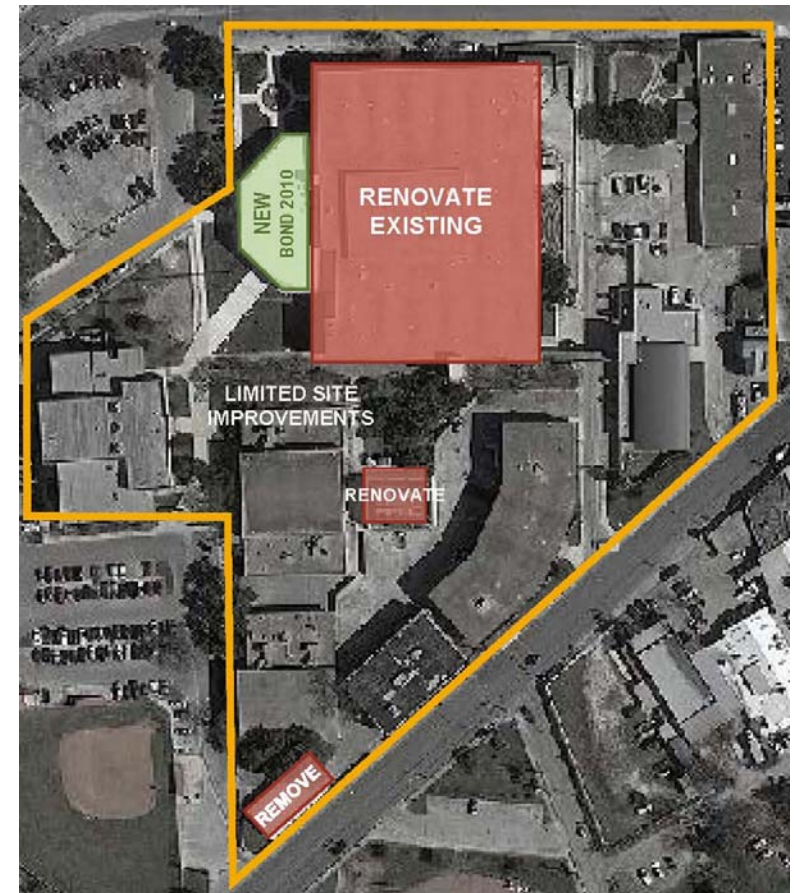

# Bond 2016 – Proposed site

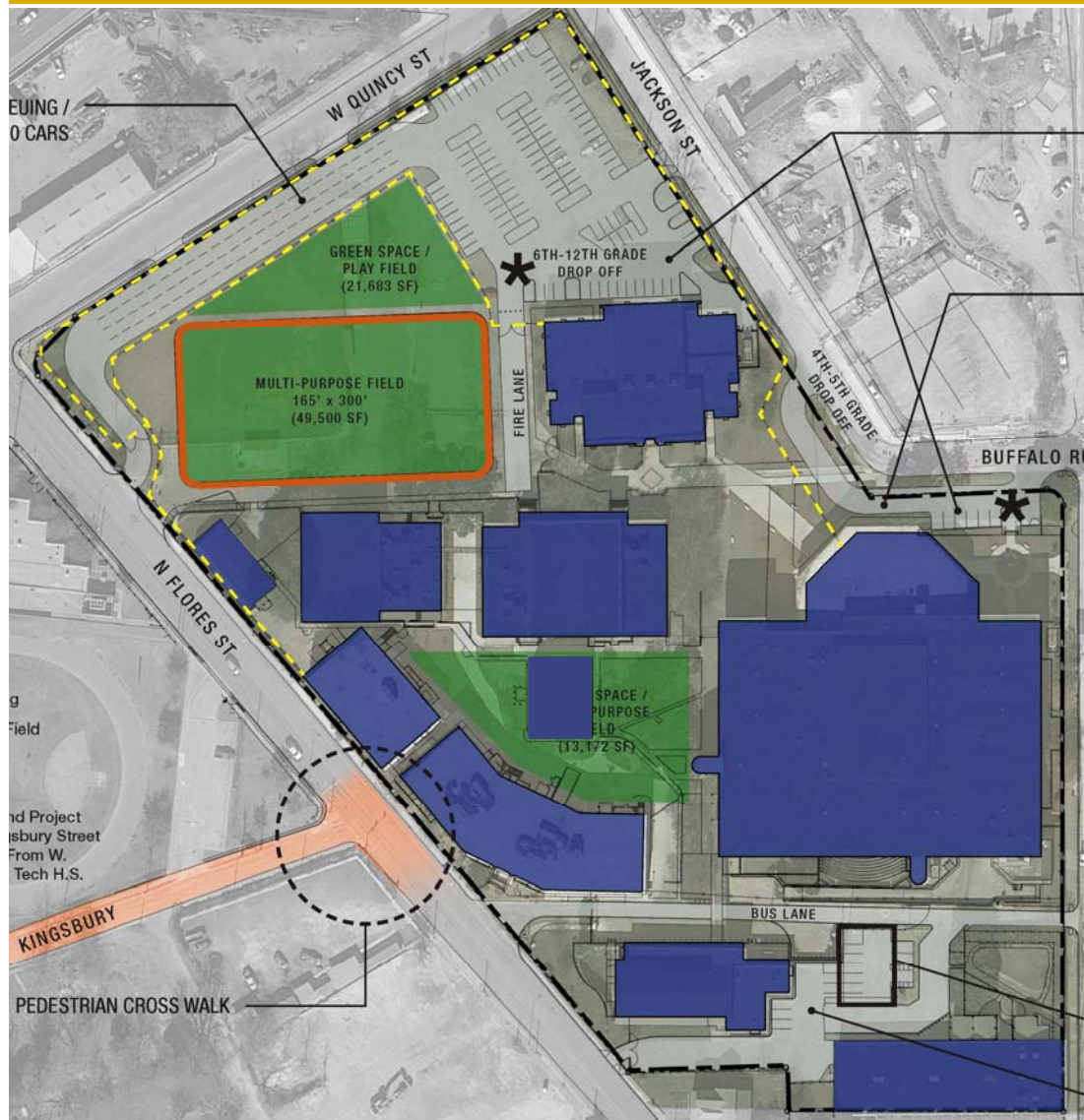

## Existing site plan



- On-site parking reduced by approximately 100 spaces
- Multi-purpose field
  - Full-size soccer field
- Green space with playground
- Walking track
- 100 car off-street queuing (6<sup>th</sup> – 12<sup>th</sup>)
- 16 car off-street queuing (4<sup>th</sup> – 5<sup>th</sup>)

# Bond 2016 – Proposed site

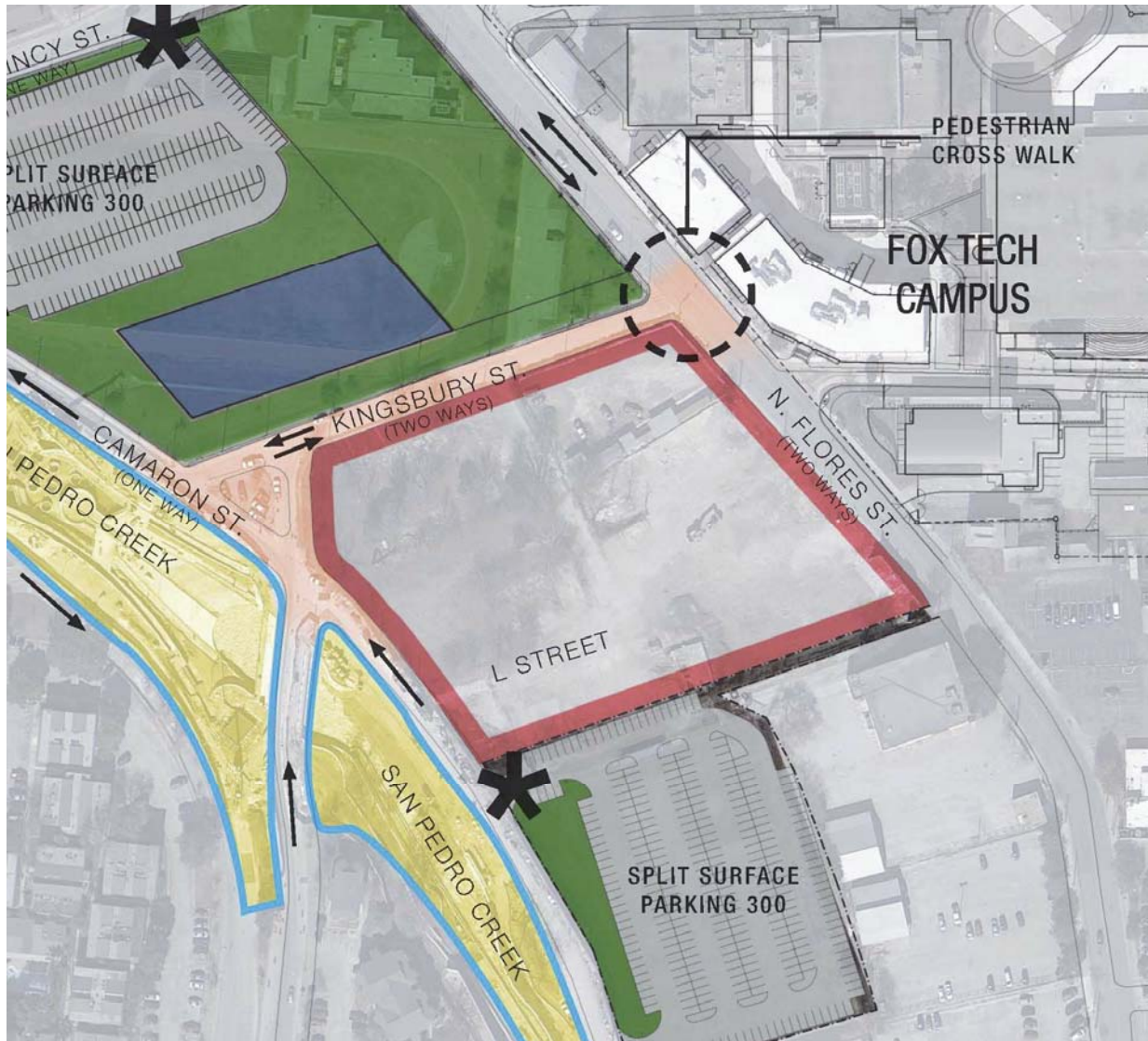

Temporary parking  
at baseball field

# Bond 2016 – First floor



## Academic renovations

- A.** Food services relocated to ground floor
  - Increase number of serving lines, from 3 to 4
  - 460 student capacity in dining
- B.** New classrooms and science labs
  - Mechanical and electrical systems upgrades
  - Acoustical treatment in mall area

- CORE ACADEMIC SPACES
- SUPPORT ACADEMIC SPACES
- ADMINISTRATION
- PUBLIC / SHARED SPACES
- BUILDING SERVICES
- CIRCULATION

# Bond 2016 – Mall renovations

---



# Bond 2016 – Classrooms

- Mechanical and electrical system upgrades
- New ceilings and finishes
- New white boards
- New flexible furniture
- New digital teaching wall



# Bond 2016 – Classrooms

- Mechanical and electrical system upgrades
- New ceilings and finishes
- New white boards
- New flexible furniture
- New digital teaching wall



# Bond 2016 – Science labs

- Mechanical and electrical system upgrades
- New ceilings and finishes
- New white boards
- New flexible furniture
- New digital teaching wall
- Combination lab and lecture space



# Bond 2016 – Science labs

---

- Mechanical and electrical system upgrades
- New ceilings and finishes
- New white boards
- New flexible furniture
- New digital teaching wall
- Combination lab and lecture space



# Bond 2016 – Second floor



## Academic renovations

- Food services relocated to ground floor
- A.** New classrooms and science labs
- B.** New maker spaces
- Mechanical and electrical systems upgrades

# Bond 2016 – Third floor



## Academic renovations

- Mechanical and electrical systems upgrades
- Restroom renovations



# Bond 2016 – Program

---

	<b>Classrooms</b>	<b>Science Labs</b>
Existing	53	6
New	15	7
Total	68	13

# Bond 2016 – Phasing Plan

## Phase 1 December 2018 – January 2019

- Temporary SPED & Office space
- Temporary classrooms

## Phase 2 January 2019 – November 2019

- Food service relocation
- New classrooms & science labs
- Mechanical upgrades throughout

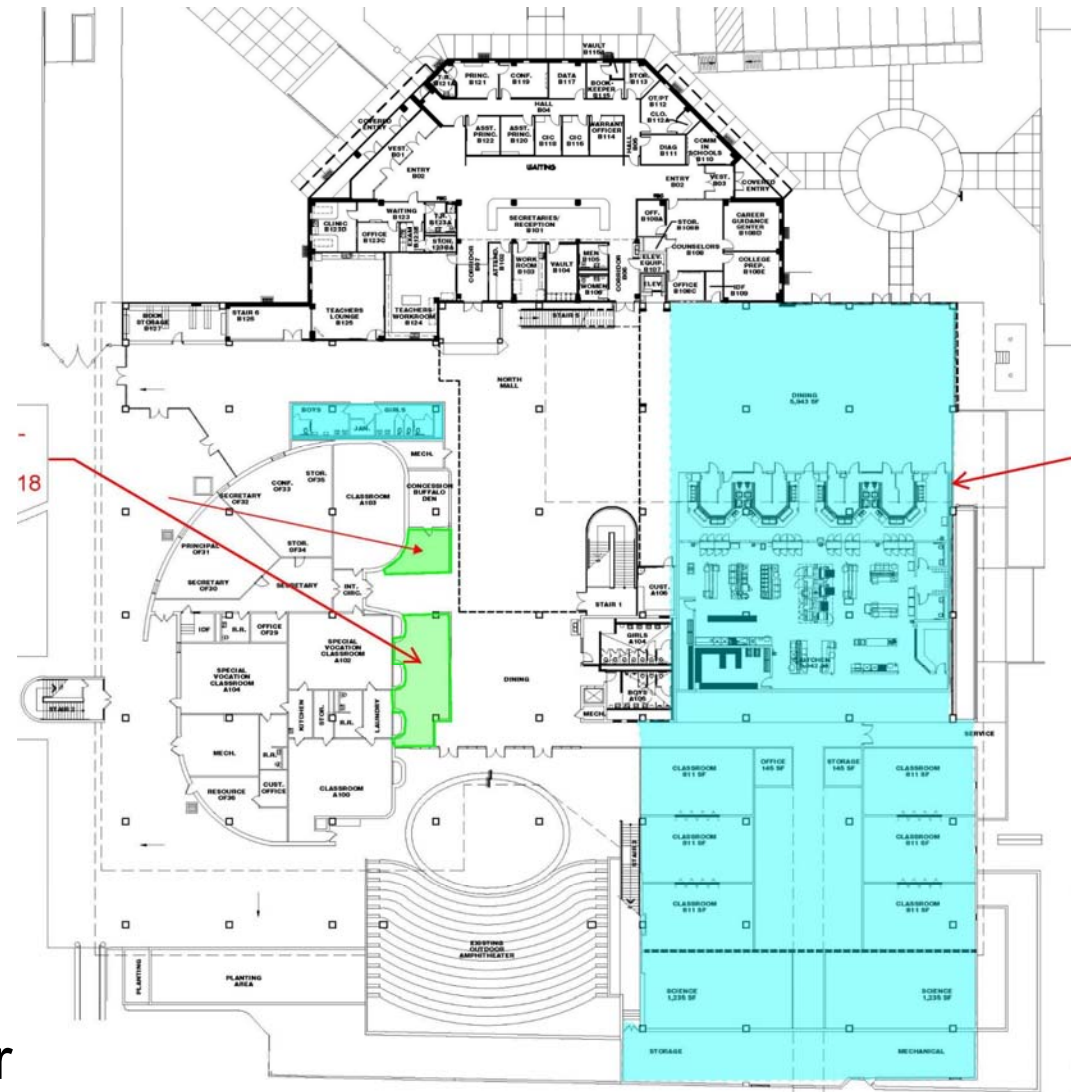

First floor

# Bond 2016 – Phasing Plan

## Phase 1 December 2018 – January 2019

- Temporary SPED & Office space
- Temporary classrooms

## Phase 2 January 2019 – November 2019

- Food service relocation
- New classrooms & science labs
- Mechanical upgrades throughout

### Phase 3 November 2019 – August 2020

- New classrooms & science labs
- New maker spaces
- Mechanical upgrades throughout

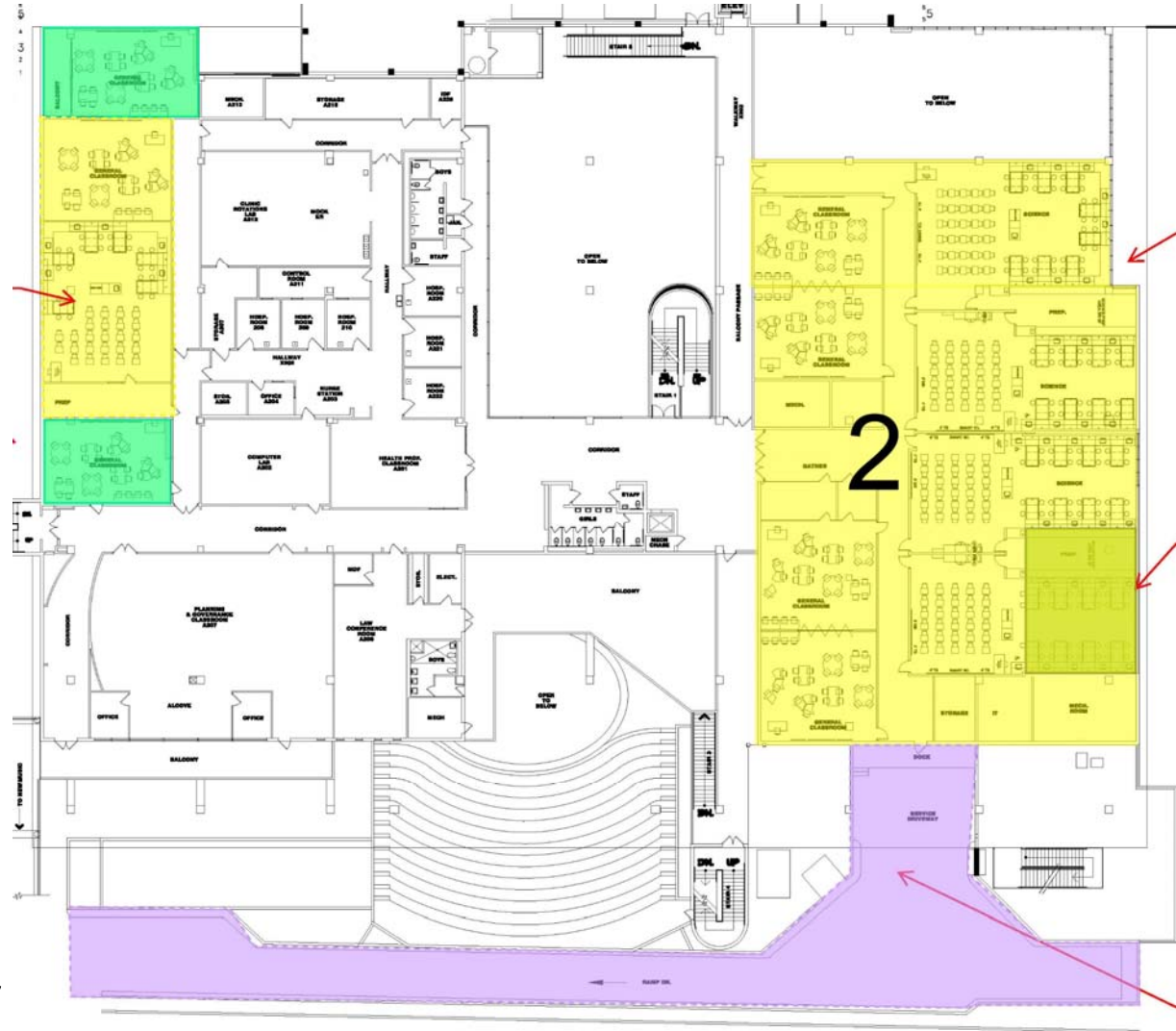

## Second floor

# Bond 2016 – Phasing Plan

## Phase 1 December 2018 – January 2019

- Temporary SPED & Office space
- Temporary classrooms

## Phase 2 January 2019 – November 2019

- Food service relocation
- New classrooms & science labs
- Mechanical upgrades throughout

## Phase 3 November 2019 – August 2020

- New classrooms & science labs
- New maker spaces
- Mechanical upgrades throughout

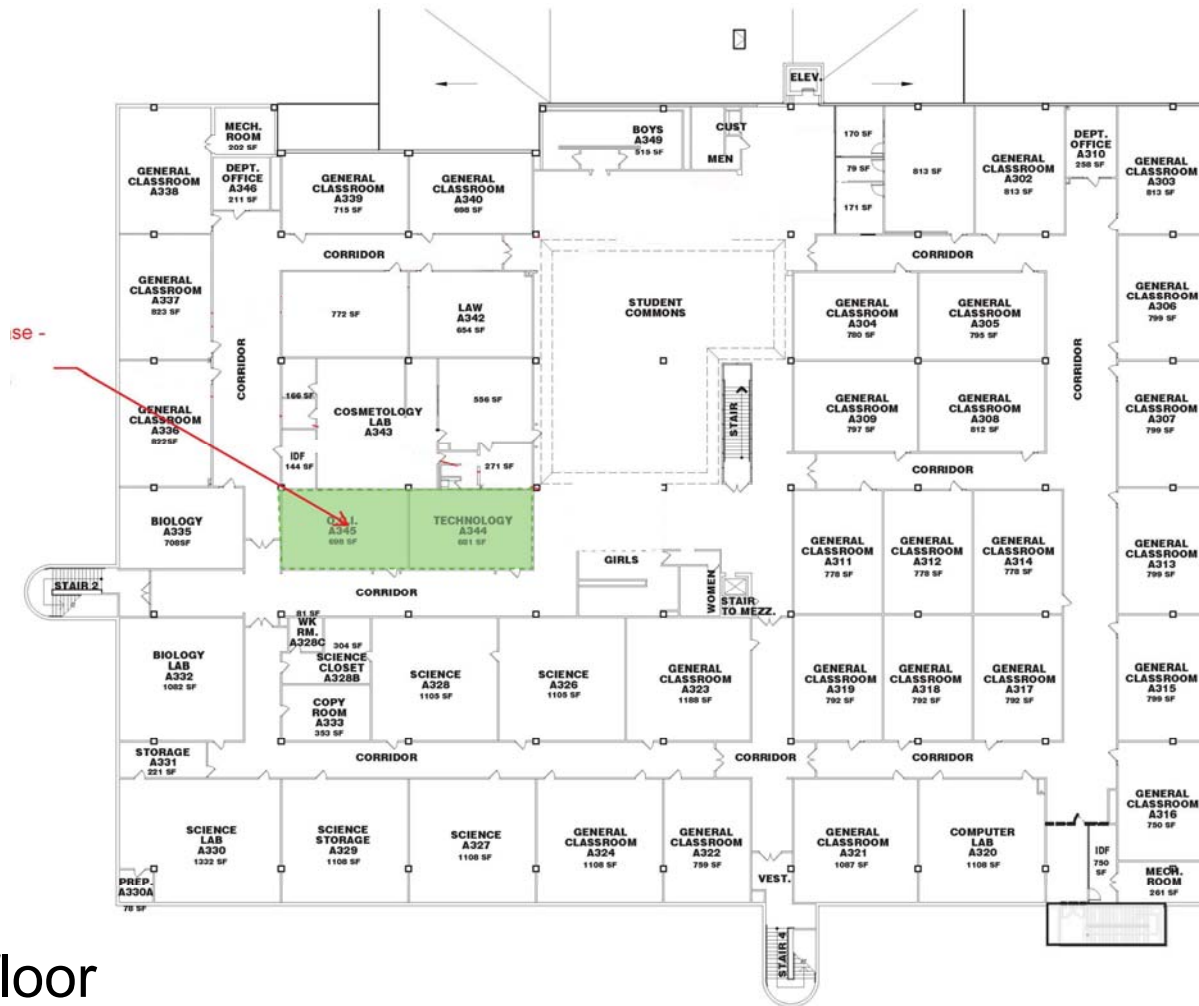

Third floor

# Bond 2016 – Mall renovations

---



# Bond 2016

---

## Questions