

Bond 2016 Community Meeting

Chief Operations Officer Willie Burroughs



Bond 2016 - Input

Community Advisory Committee – Quarterly meetings, beginning June 14, 2017 District 1 Committee Members

- Brian Dillard
- Shannan Hern
- John Wilkins

Scope priority meeting – January 8, 2018

- Anita O’Neal, former Principal
- Nicole Washington
- Michael Gomez
- Roberto Muñoz

Program review meeting – February 13, 2018

- Anita O’Neal, former Principal
- Michael Gomez

Project Advisory Team meeting – March 22, 2018

- Anita O’Neal, former Principal
- Nicole Washington
- Michael Gomez
- Roberto Muñoz

Bond 2016 - Input

Stakeholder meeting – September 25, 2018

- Steve Lecholop, Trustee
- Yvonne Martinez, Associate Principal

Bond 2016 - Scope

Total Project Budget: \$11,078,573

Renovations and upgrades to include:

- Classroom spaces (general learning, science, art, music, special education)
- Restrooms
- Cafeteria/kitchen
- Stage
- Heating, ventilation and air conditioning
- Plumbing and electrical
- Technology infrastructure for new and renovated spaces
- Lighting
- Fire sprinkler systems
- Special needs accessibility in entryways, restrooms, and other areas
- Front-entry modifications to improve security
- Roofing, building exterior and site improvements



Bond 2016 – Proposed site



- ① NEW CLASSROOM WINDOWS
- ② FRONT ENTRY SECURITY IMPROVEMENTS
- ③ SITE DRAINAGE
- ④ NEW ROOF
- ⑤ ATHLETIC FIELD MODIFICATIONS



Bond 2016 – First floor

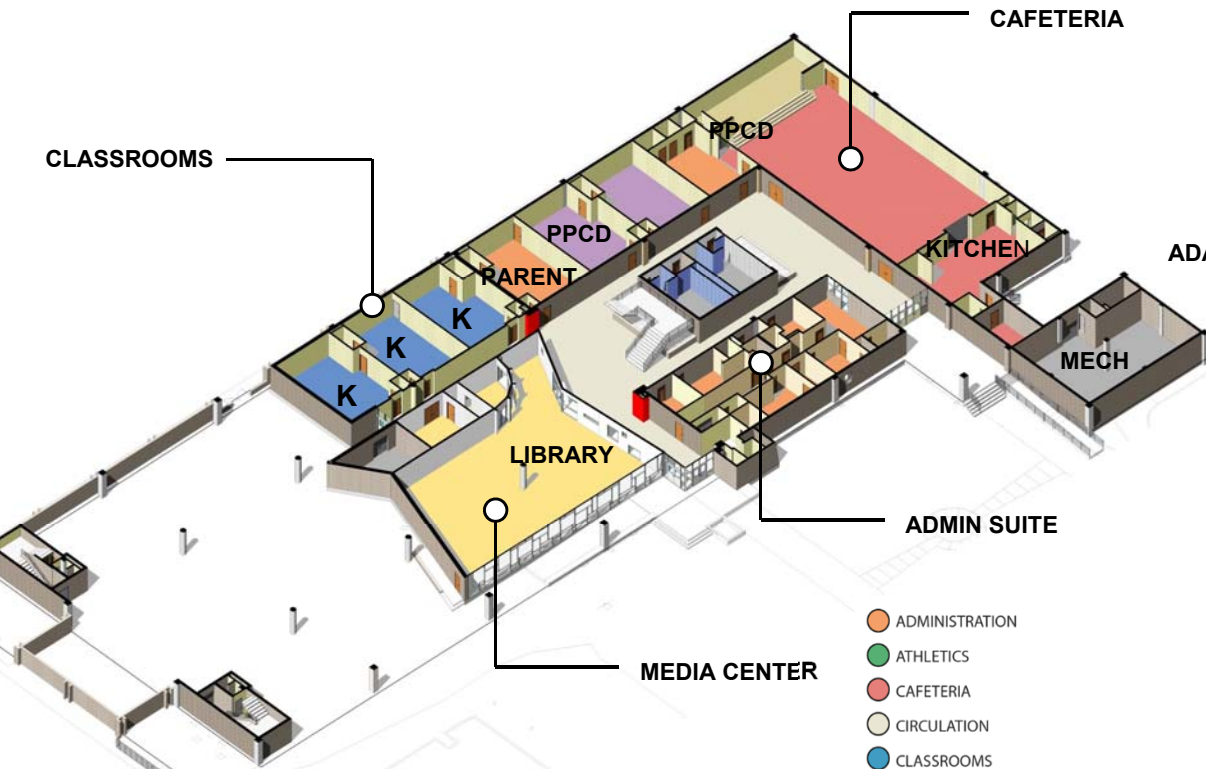

Existing first floor plan

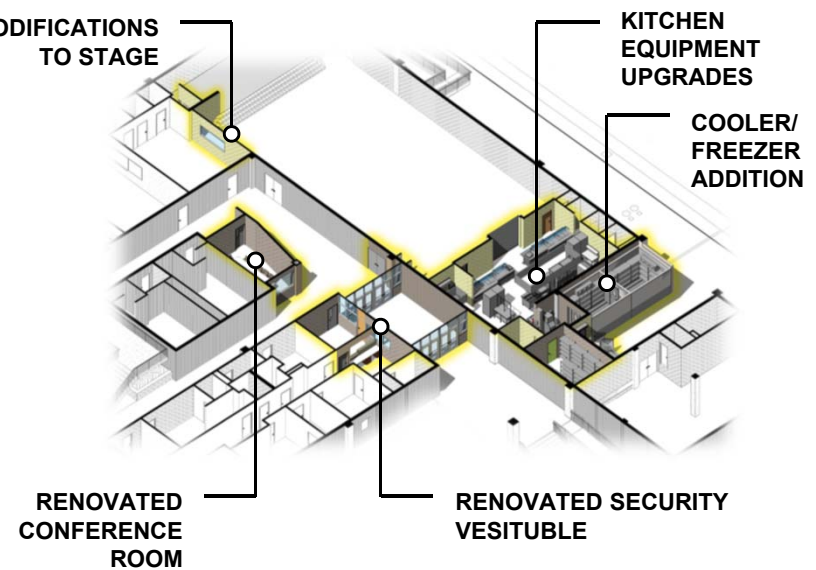

Proposed first floor renovations

Bond 2016 – First floor

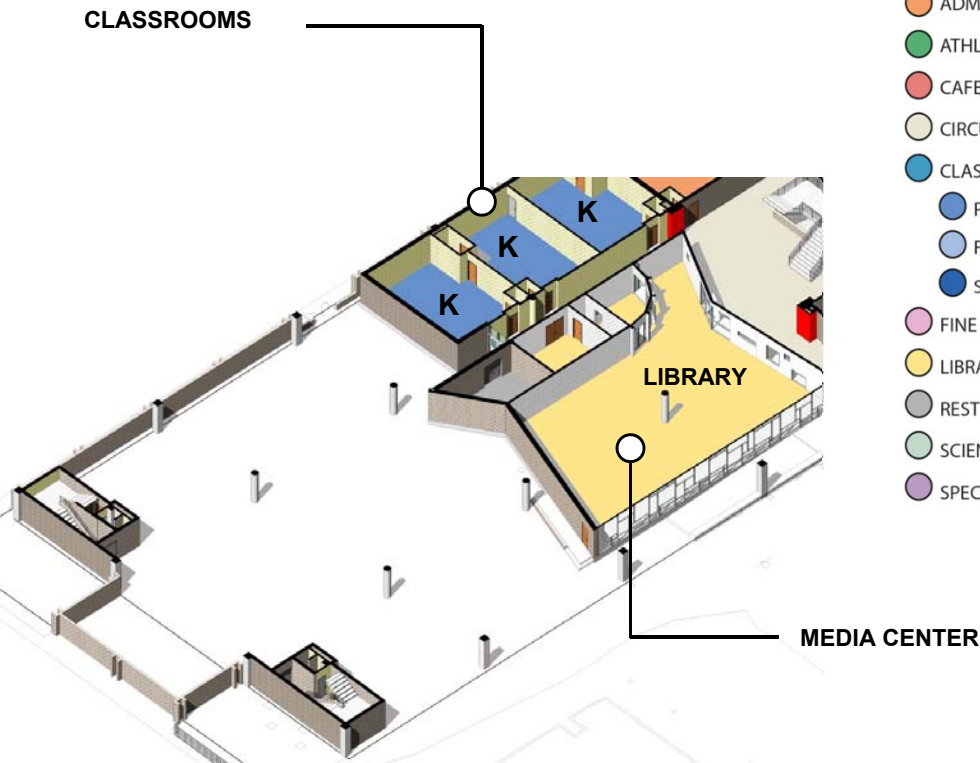

Existing first floor plan

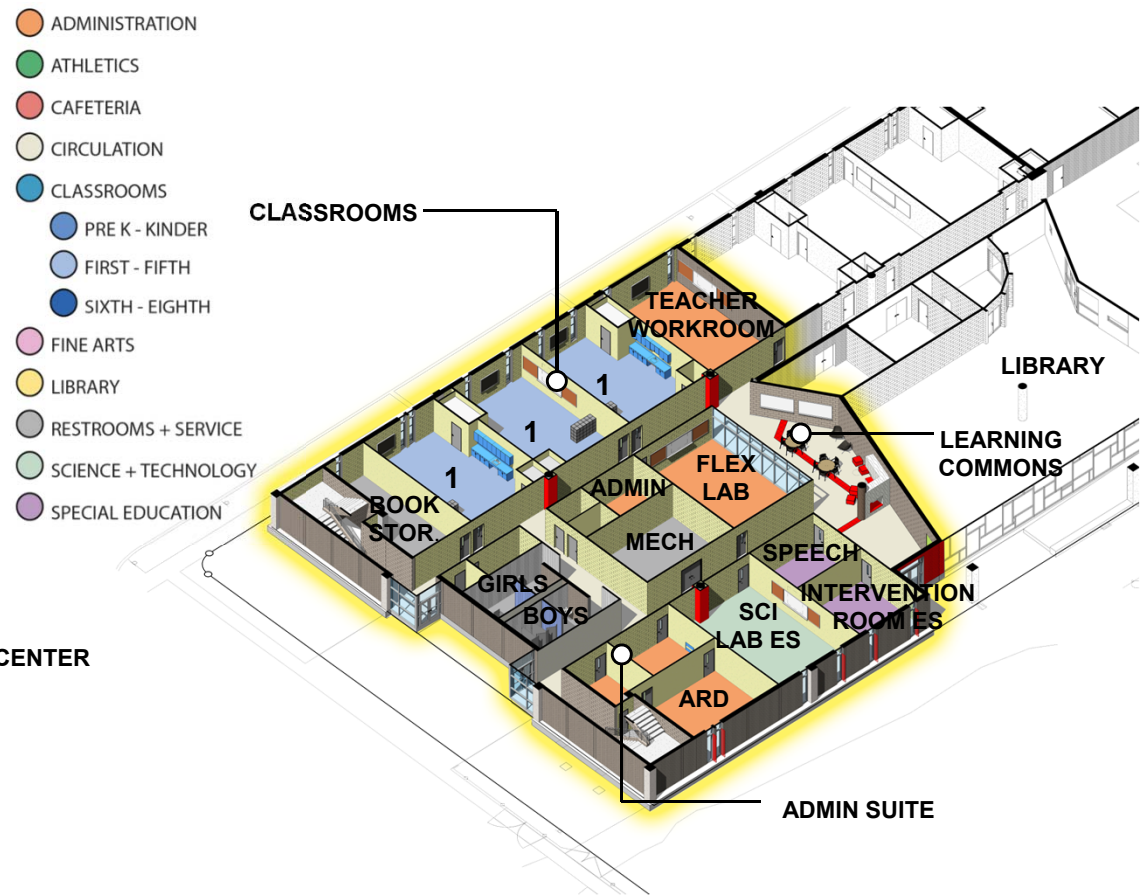

Proposed first floor infill

Bond 2016 – First floor

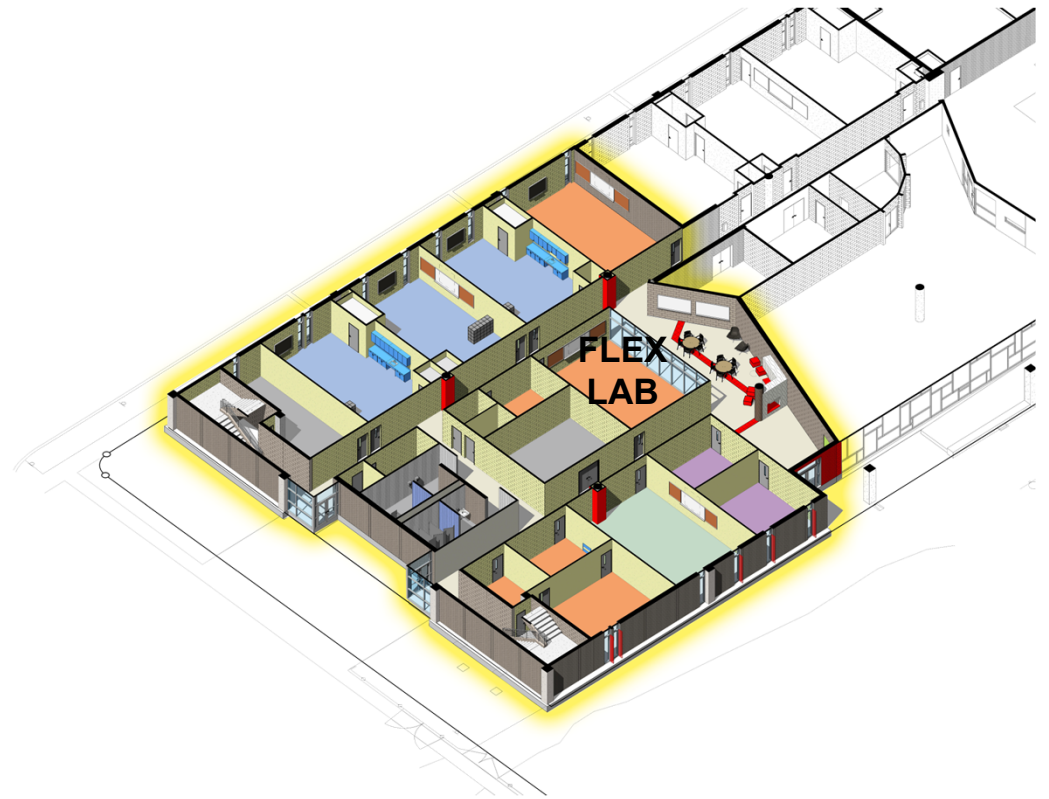

Proposed Flex Lab

Bond 2016 – Second floor

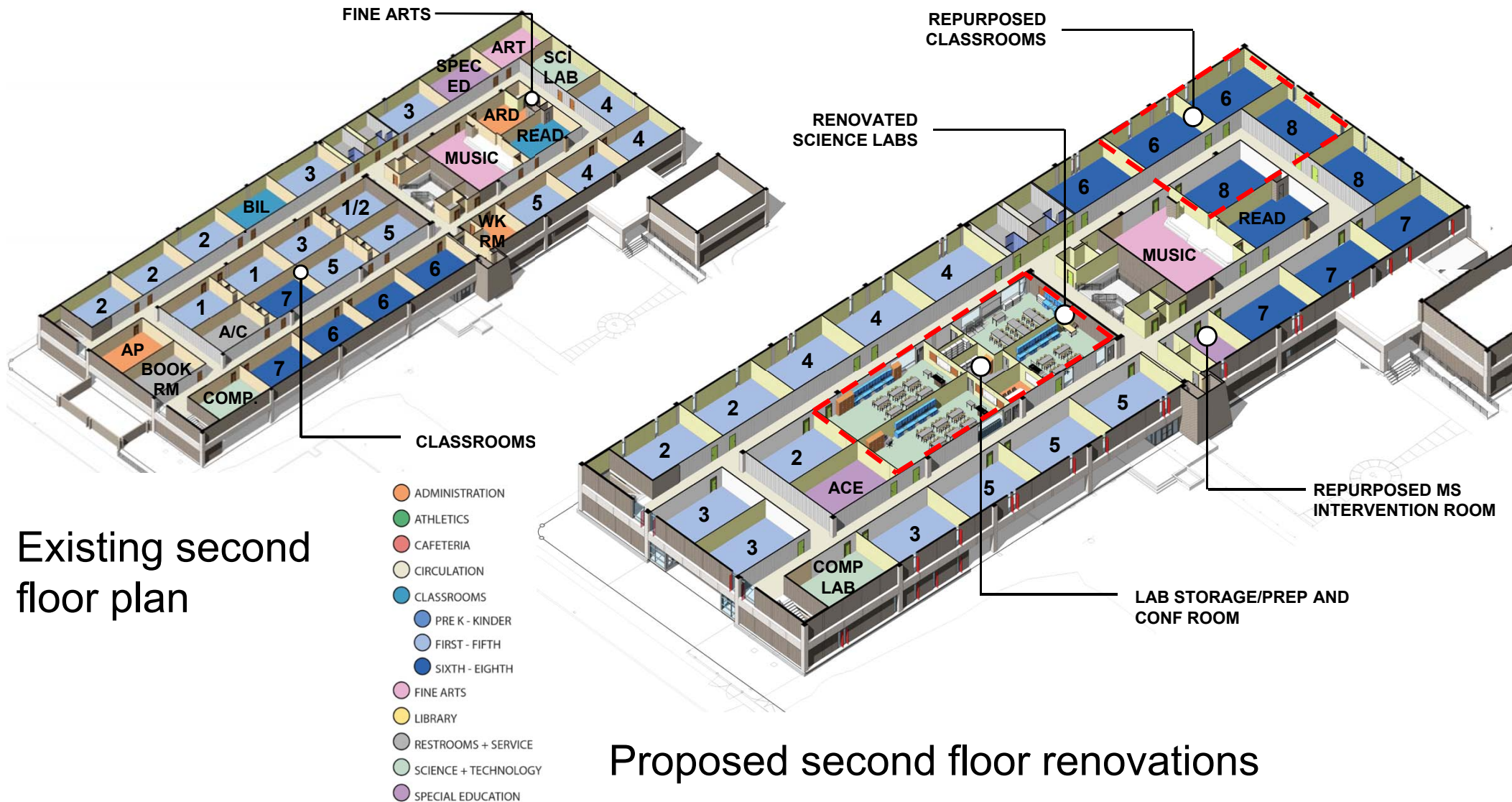

Bond 2016 – Exterior



Bond 2016 – Classrooms



- Mechanical and electrical system upgrades
- New ceilings and finishes
- New storage cubbies
- New white boards
- New flexible furniture
- New digital teaching wall



Bond 2016 – Science labs



- Mechanical and electrical system upgrades
- New ceilings and finishes
- New wall cabinets
- New white boards
- Flexible lab furniture
- New digital teaching wall



Bond 2016 – Phasing

Phase One

- New infill (addition)
- New roof
- Preparation for summer work

November 2018 – June 2019

Phase Two

- Interior renovations
- New exterior windows

July 2019 – December 2019

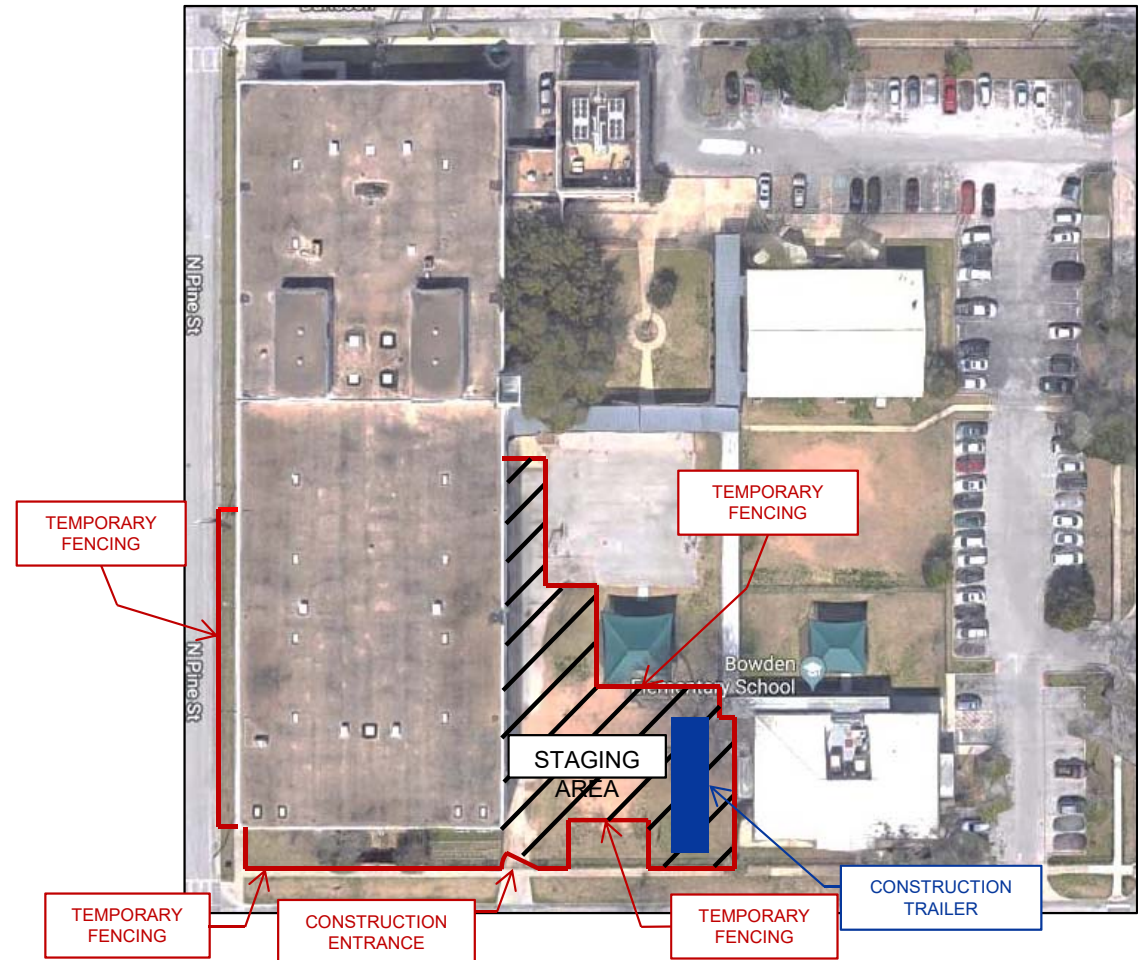

Bond 2016

Questions